

HUROM[®]

Slow Juicer

HU-100

Instruction Manual

Please read the instructions carefully before using.

Please keep this user's guide where it is easily accessible.

Design and product development may be upgraded without a public notice.

<http://www.hurom.com>





Hurom

Enjoy the pure flavor and wellness of nature with **HUROM**

HUROM gently presses to retrieve juice rather than forcing juice by shredding and grinding.

HUROM is a newly developed patent technology which can retrieve juice not only from fruits and vegetables but also from soy as well.

HUROM is also capable in making organic tofu, wheatgrass shot, ice cream, and so much more...

For better use and proper maintenance, please follow the instructions carefully. Please refer to user's manual when times of technical difficulties or unsure of the usage of this product. We are not liable for any injuries or damages that may occur due to the lack of understanding of the user's manual .

CONTENTS

- 02 Attachment Listing
- 04 Safety Precautions
- 09 Assembly Instruction (Type1)
- 10 Assembly Instruction (Type2)
- 13 How to use HUROM slow juicer
- 14 Warning while operating
- 15 How to disassemble and clean
- 16 Troubleshooting
- 18 Product Specification

Attachment Listing

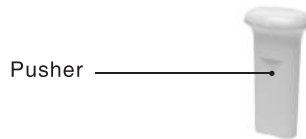
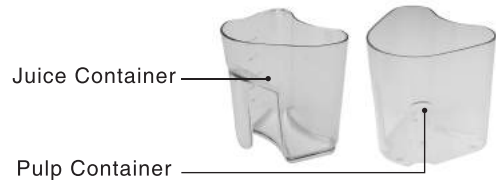
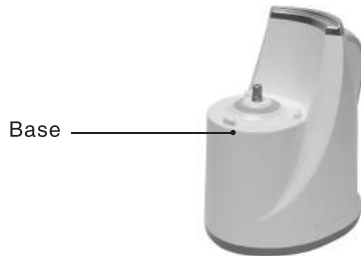
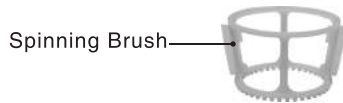
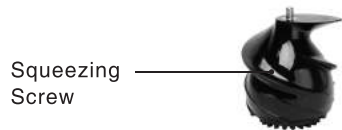
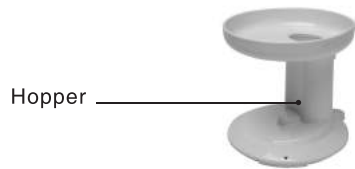



Attachment Listing

- Hopper (1EA)
- Squeezing Screw (1EA)
- Strainer (1EA)
- Spinning Brush (1EA)
- Bowl (1EA)
- Base (1EA)
- Container (2EA)
- Pusher (1EA)
- Cleaning brush (1EA)



As shown above, the hopper edge must point to "close" on the base in order for the machine to operate properly.

Safety Precautions

Please read carefully before using.
Please follow instruction to avoid injuries.

Warning
sign



Warning : Violating this sign may lead to serious injury or even death.



Caution : Violating this sign may lead to serious damage to the product.

Example



Sign (Danger in health)



Sign (Must not do)



Sign (Restrictions)

Warning



Do not plug or unplug the electrical plug with wet hands.

Can cause electricution.



Do not use other than right volt power.

Can cause electricution, fire, or product damage.

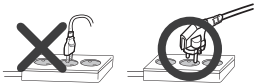

Please plug in your outlet properly.

Not doing so may cause fire damage.





Do not force plug into outlet, ensure plug is away from any heat source and is not bent or, twisted in anyway.

May cause electrocution or fire.



Do not disassemble the base. Please consult with repair technician for trouble shooting.

Violating these instructions may cause electrocution or fire.
All repairs must be done at your purchased retail store.



Stop use when the electrical cord is damaged or loose.

Violating these instructions may cause electrocution or fire.

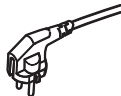

Do not put any unknown substance into the machine.

Violating these instructions may cause electrocution or fire.



Keep the base dried at all times.

Violating these instructions may cause electrocution or fire.



Keep away from children or any personnel who aren't familiar with the usage of this product.

Violating these instructions may cause electrocution or fire.



Do not disassemble any parts while operating the machine. Do not put in any unknown objects while operating the machine.

Violating these instructions may cause injuries or damage to the product.

Safety Precautions

Caution



Do not operate when the hopper is loose.

Violating these instructions may cause electrocution or fire.



Do not unplug the outlet when there is a gas exposure, instead open all windows for air ventilation.

Violating these instructions may cause electrocution or fire.



Operate on a flat and steady surface.

Violating these instructions may cause injuries or damage to the product.



Do not put in any objects that are not instructed inside the machine.



Do not remove while operating.

Violating these instructions may cause injuries or damage to the product.



Should the squeezing screw jam, put in reverse for 2-3 seconds then try operating again.

Violating these instructions may cause injuries or damage to the product.



Do not disassemble while operating.

Violating these instructions may cause injuries or damage to the product. Please disassemble after the power is off.



Do not use anything other than the pusher.

Violating these instructions may cause injuries or damage to the product.



Do not use more than 30 minutes continuously.

Do not use more than 30 minutes continuously.



Do not submerge the motor in water.

Violating these instructions may cause injuries or damage to the product.



After use, remove the plug from the outlet.

Do not use cord to remove plug.



While using, if there is any unusual odour(heat, smoke) stop use immediately and contact the nearest retail center where you purchased the product.



The base weighs 6.2kg so please lift the unit with two hands.

Violating these instructions may cause injuries or damage to the product.



Do not rinse with water that is warmer than 80°C.

Violating these instructions may cause injuries or damage to the product.

Enjoy the pure flavor and wellness of nature with **HUrom**



Assembly instruction – Type 1

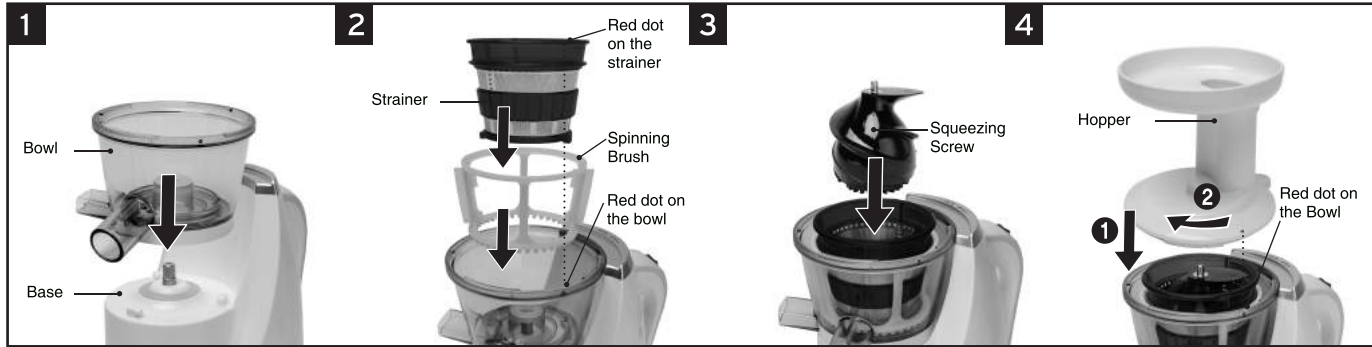

1. Assemble the bowl on the base.

- ① Make sure the bowl is all the way into the shaft of the base.
- ② Twist the bowl to close.

2. Assemble the strainer + spinning brush into the bowl.

- ① Make sure the red dot on the strainer and the red dot on the bowl are aligned.

3. Place the squeezing screw in the center of the bowl.

4. Assemble the hopper onto the bowl.

- ① Make sure the arrow on the hopper and the red dot on the bowl are aligned.
- ② Make sure the arrow on the hopper is pointing to "close" on the base.



Reverse the step carefully when disassembling.

Assembly instruction – Type 2

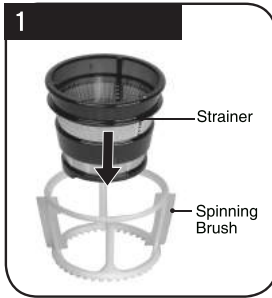

Place the strainer into the spinning brush

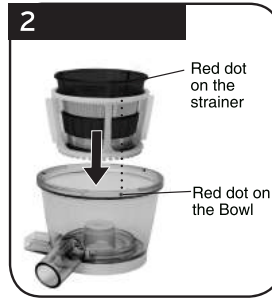

Place the strainer + spinning brush into the bowl.

① Make sure the red dot on the strainer and the red dot on the bowl are aligned.

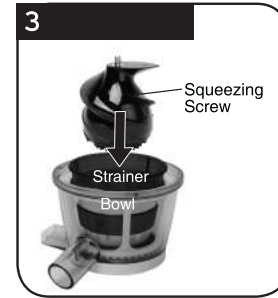

Push the squeezing screw into the strainer.

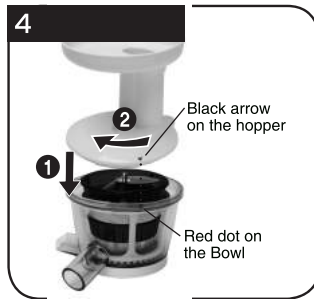

Assemble the hopper onto the bowl.

- ① Make sure the arrow on the hopper and the red dot on the bowl are aligned.
- ② Make sure the arrow on the hopper is pointing to "close" on the base.

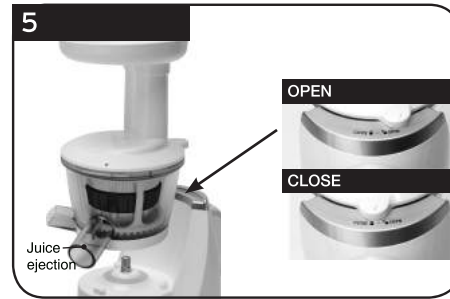

Assemble the entire Top Set onto the base.

- ① As shown left, assemble the bowl onto the base and twist the bowl so that hopper edge is pointing to "close" on the base.

Assembly instruction – Type 1,2

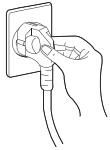

Must connect the power cord.

**Place containers under both ejections.
(Juice & pulp ejection)**

Assembling rubber packing after cleaning

After cleaning, please plug back in the rubber packing as shown in below pictures. Underneath the bowl, there is a yellow rubber pad which allows all the juice to only discharge from the fresh juice ejection.

The rubber pad is removable. Simply grab onto one side of the rubber pad and pull out.

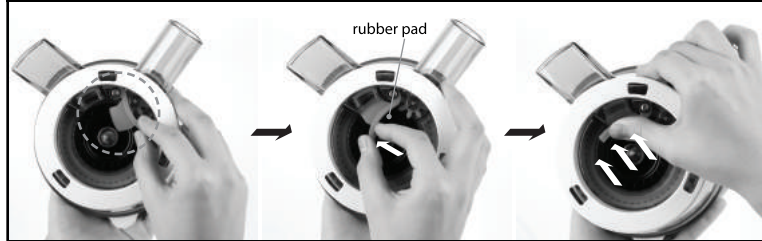

HUROM[®]
Slow Juicer

How to use HUROM Slow Juicer



The machine has three(3) settings.

- ▶ “On” starts motor, start making juice.
- ▶ “Rev” is reverse. Only use when something is stuck and you need to unclog.
- ▶ “Off” is at center position. This allows the machine to turn off.



Please rinse everything thoroughly before putting into the machine.

After rinsing, put material into the machine using the pusher.
Please remove any hard seeds before using.
Please cut or split any hard materials such as carrot into thin slices before inputting into the machine.



Turn off the machine after using.

Please dry your hands before touching the power switch.



Warning

Do not operate with wet hands.
Do not pre-operate before inputting materials or Do not operate with an empty bowl.

Warning while operating



Do not use longer than 30 minutes at a time.

Violating the warning may cause serious damage to the product.



Remove any hard seeds.

Violating the warning may cause serious damage to the product especially the screw.



Do not use anything as a pusher (fork, chopsticks, spoons, etc) other than the pusher itself.

Violating the warning may cause serious damage to the product.



Do not operate with wet hands.

Violating the warning may cause serious injuries or electrocution.

When the machine is stuck and not operable, Please...

ON

OFF

REV

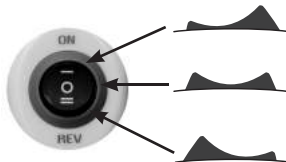

Turn off the machine and put it reverse for few seconds then try operating again.

When reverse switch does not work, turn off the machine and reassemble following the instructions given. After reassemble, please try turning on the machine.



Warning

please reassure the switch is completely dry before operating

How to disassemble and clean

1 Turn machine "OFF".

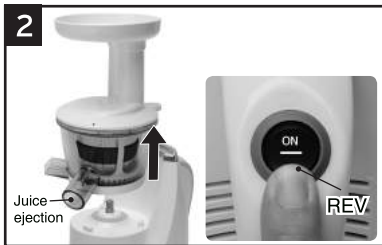

Twist the hopper to unlock by grabbing the two ejections. Make sure the edge is aligned to "open" before pulling off the bowl.



Order to disassemble.

1. Hopper
2. Squeezing screw
3. Strainer
4. Spinning brush
5. Bowl



Use the brush to clean thoroughly after operating.

5 Do not rinse the base with direct water, use dry towel or wet towel to clean.

6 Please dry the attachments after cleaning.



Warning

Please use smooth wet towel for cleaning the base.

Please do not use dish washer or high temperature cleaner for cleaning

HUROM Troubleshooting

	<i>Problem</i>	<i>Possible Reasons</i>	<i>Solution</i>
1	Bowl is stuck and does not detach from the base.	Excessive food in the bowl. Unknown substance in the bowl.	Press reverse switch 3-5 seconds. Repeat process 2-3 times. Then, push bowl upward while turning.
2	Hopper / lid is stuck.	Excessive food in the bowl. Unknown substance in the bowl	Press reverse switch 3-5 seconds. Repeat process 2-3 times. Then, press down on top of lid while turning.
3	Motor is stuck or has stopped.	Excessive food in the bowl. Safety feature: automatic shutoff due to overheating.	Press reverse switch 3-5 seconds. Repeat process 2-3 times. If motor has stopped, let cool down before trying again.
4	Leaking from underneath the bowl.	Extraction packing not plugged in correctly.	Be sure to plug in extraction packing tightly after cleaning.
5	Squeaking noise when juicing.	Friction between the squeezing screw and bowl or food.	Squeaking sound is perfectly normal. Do not run the juicer without any food.
6	The unit vibrates.	Sign of motor working properly.	Vibration is perfectly normal. However, severe shaking which causes imbalance of the unit should be checked for a defective screw.

HUROM Troubleshooting

	<i>Problem</i>	<i>Possible Reasons</i>	<i>Solution</i>
7	Water mark or scratch on the squeezing screw.	Molding marks during manufacturing process.	These marks and lines on the squeezing screw are perfectly normal.
8	Color stain on the bowl, strainer, spinning brush	Natural dye from food.	Hurom is chemical-free on all attachments. Therefore natural dye from food when juicing is perfectly normal. To reduce staining, rinse and clean immediately after each use. Diluted vinegar or the similar can be used.
9	Mold in silicone part of spinning brush.	Poor cleaning.	Be sure to clean thoroughly by detaching the silicone brushes from the spinning brush. Don't forget to plug it back in before juicing.
10	Strainer damage.	Ice, frozen foods, large hard seeds or pits, unknown substance, or excess food in bowl.	Refer to instruction manual for proper usage and juicing tips. Remember not to overcrowd food or force foods in.
11	Deformation of attachments.	Exposed to heat or abrasive materials.	Do not clean any attachments in dishwasher or use hard cleaners. Plastic tends to deform when exposed to high heat.
12	Too much pulp coming out.	Excess food in bowl clogging up the strainer or food not cut into small pieces.	Cut food, especially fibrous food, into smaller pieces to avoid the fibers wrapping around the screw. Also input food at a slow pace allowing all the pulp to eject before adding more food.

Product Specification



Specification		
Product Name	HUROM Slow Juicer	
Model Name	HU - 100	
Voltage	230 - 240V	
Frequency	50Hz	
Power Consumption	150w	
RPM	70 rpm	
Electrical cord length	1.4 M +	
Motor	Single-Phase induction	
Weight	6.2 kg	
Dimensions	Width	155 mm
	Length	213 mm
	Height	400 mm
Standard usage time	Less than 30 minutes continuously	

WARRANTY

This certifies that the Hurom Slow Juicer is warranted by **HUROM** to be free from defects in material construction and workmanship.

The motor is warranted for five (5) years and other parts are warranted for one (1) year from the date of purchase to the original purchaser.

This warranty does not apply to damages caused by accident, misuse, abuse, commercial use, alteration, failure to follow operating instructions, or damage caused by parts or service unauthorized by **HUROM**. Damages caused by transportation must be claimed with the carrier.

HUROM disclaims all responsibilities for consequential damages from incidental losses caused by use of this appliance.

If service should be necessary, please contact our local customer service for technical difficulty.

Registration Information

Model

Serial Number

Place purchased

Date purchased

Purchaser

Address

E-mail

Important : To better protect your purchase, fill out and mail this form to a local distributor where you have purchased, and keep the original receipt.

HUROM[®]

Slow Juicer

<http://www.hurom.com>