

Instruction Manual

CONTENTS

- 02** Important safeguards
- 03** Precautions
- 04** Parts and Accessories
- 06** Disassembling the chamber
- 07** Preparing ingredients / Use by strainer type
- 08** Assembling the chamber for juicing
- 10** Assembling the chamber for making ice cream
- 12** Assembling the chamber set and body
- 13** Cautions during operation
- 14** Using the product : For juicing / For ice cream
- 15** Using the control lever by mode
- 16** Using the control lever by ingredient (Juicing)
- 17** If the squeezing screw stops during operation
- 18** Assembling and cleaning the squeezer accessory
- 19** Using the squeezer
- 20** Cleaning : Silicone parts
- 22** Troubleshooting
- 24** Product specifications / Warranty

H-AF Series (Household use only / Warranty included)

- 01. Read the instructions carefully before using.
- 02. Keep these instructions somewhere easily accessible.
- 03. Use only with 120V AC power supply.
- 04. Design and product development may be upgraded without notice.
- 05. Any quality improvements are subject to change without notice.

02 **IMPORTANT SAFEGUARDS**

1. **WHEN USING ELECTRICAL APPLIANCES, BASIC SAFETY PRECAUTIONS SHOULD ALWAYS BE FOLLOWED. READ ALL INSTRUCTIONS.**
2. **TO PROTECT AGAINST RISK OF ELECTRICAL SHOCK, DO NOT PUT THE MAIN BODY (MOTOR) IN WATER OR ANY OTHER LIQUID.**
3. **CLOSE SUPERVISION IS NECESSARY WHEN ANY APPLIANCE IS USED NEAR CHILDREN.**
4. **UNPLUG FROM OUTLET WHEN NOT IN USE, BEFORE ASSEMBLING OR TAKING OFF PARTS AND BEFORE CLEANING.**
5. **AVOID CONTACT WITH MOVING PARTS.**
6. **DO NOT OPERATE ANY APPLIANCE WITH A DAMAGED CORD OR PLUG, AFTER THE APPLIANCE MALFUNCTIONS, OR IS DROPPED OR DAMAGED IN ANY MANNER. RETURN APPLIANCE TO THE NEAREST AUTHORIZED SERVICE FACILITY FOR EXAMINATION, REPAIR OR ELECTRICAL OR MECHANICAL ADJUSTMENT.**
7. **THE USE OF ATTACHMENTS NOT SOLD OR RECOMMENDED BY THE MANUFACTURER MAY CAUSE FIRE, ELECTRIC SHOCK OR INJURY.**
8. **DO NOT LET CORD HANG OVER EDGE OF TABLE OR COUNTER.**
9. **ALWAYS MAKE SURE HOPPER IS SECURELY FASTENED IN PLACE BEFORE MOTOR IS TURNED ON. DO NOT UNFASTEN HOPPER WHILE JUICER IS IN OPERATION.**
10. **TURN SWITCH TO OFF POSITION AFTER EACH USE OF YOUR JUICER. MAKE SURE THE MOTOR STOPS COMPLETELY BEFORE DISASSEMBLING.**
11. **DO NOT PUT YOUR FINGERS OR OTHER OBJECTS INTO THE JUICER WHILE IT IS IN OPERATION. IF FOOD BECOMES LODGED IN OPENING, USE FOOD PUSHER OR ANOTHER PIECE OF FRUIT OR VEGETABLE TO HELP IT DOWN. IF THIS METHOD IS NOT POSSIBLE, TURN THE MOTOR OFF AND DISASSEMBLE JUICER TO REMOVE THE REMAINING FOOD.**
12. **DO NOT USE OUTDOORS.**
13. **DO NOT PLACE ON OR NEAR A HOT GAS OR ELECTRIC BURNER OR IN A HEATED OVEN.**
14. **DO NOT USE APPLIANCE FOR OTHER THAN INTENDED USE.**

SAVE THESE INSTRUCTIONS

03



PRECAUTIONS FOR SAFE USE

- **DO NOT PLUG OR UNPLUG WITH WET HANDS.** It may cause electric shock or injury.
- **DO NOT USE OTHER THAN 120 V AC.**
It may cause electric shock, fire or product failure. If the voltage is different, it may shorten the life of the motor or cause a failure.
- **PLUG THE POWER CORD CORRECTLY AND PUSH IT TIGHT IN A WALL SOCKET.** It may cause an electric shock or a fire.
- **IF THE POWER CORD, WIRE IS BROKEN OR DAMAGED, OR THE PLUG-IN PART BECOMES LOOSE, DO NOT OPERATE IT.**
It may cause electric shock, fire or injury.
- **NEVER ALTER THE APPLIANCE. ALSO, DO NOT DISASSEMBLE OR REPAIR THE PRODUCT BY YOURSELF. DO NOT INSERT FINGERS, FOREIGN SUBSTANCES OR OBJECTS SUCH AS PINS INTO GAPS OR HOLES IN THE BODY.**
It may cause a fire, electric shock or product failure. For any technical support, contact the authorized local Customer Service Center.
- **WHEN THE POWER CORD, WIRE IS BROKEN OR DAMAGED, OR THE PLUG-IN PART BECOME LOOSE, DO NOT OPERATE IT.**
It may cause electric shock, fire or injury.
- **DO NOT MOISTEN BODY OR SPLASH WATER ON THE BODY.**
Be careful to not let any liquids or other substances get into the switch of the appliance.
- **DO NOT OPERATE THE SWITCH WITH WET HANDS.** It may cause an electric shock or fire.
- **FOR SAFETY, MUST DO GROUNDING CONNECTION. ALSO, DO NOT DO THE GROUNDING ON GAS PIPE, PLASTIC WATER PIPE, TELEPHONE WIRE, ETC.**
It could cause electric shock, fire, malfunction or explosion. Be sure to use the electrical outlet with ground connection.
- **NEVER DISASSEMBLE THE CHAMBER SET DURING OPERATION OR INSERT FINGERS, FOREIGN OBJECTS SUCH AS FORKS, SPOONS, ETC. INTO HOPPER CHUTE OR JUICE OUTLET.** It may cause injury, accident or product failure.
- **APPLIANCES CAN BE USED BY PERSONS WITH REDUCED PHYSICAL, SENSORY OR MENTAL CAPABILITIES OR LACK OF EXPERIENCE AND KNOWLEDGE IF THEY HAVE BEEN GIVEN SUPERVISION OR INSTRUCTION CONCERNING USE OF THE APPLIANCE IN A SAFE WAY AND IF THEY UNDERSTAND THE HAZARDS INVOLVED. CHILDREN SHALL NOT PLAY WITH THE APPLIANCE. CLEANING AND USER MAINTENANCE SHALL NOT BE MADE BY CHILDREN. THIS APPLIANCE SHALL NOT BE USED BY CHILDREN. KEEP THE APPLIANCE AND ITS CORD AWAY FROM CHILDREN.**
- **DO NOT OPERATE WITHOUT LOCKING THE HOPPER PROPERLY.** It may cause an injury or a failure.
- **WHEN A GAS LEAK IS DETECTED, DO NOT INSERT THE POWER CORD INTO ITS SLOT. OPEN THE WINDOW IMMEDIATELY FOR AIR VENTILATION.** It may cause injury or failure.
- **NEVER PUT A FINGER, FORK OR SPOON, ETC. INTO JUICE OUTLET.** It may cause injury or failure.
- **IF ROTATION OF SQUEEZING SCREW IS STOPPED DURING NORMAL OPERATION, PRESS [REVERSE] BUTTON AND HOLD FOR 2~3 SECONDS AND AFTER REVERSE OPERATION IS COMPLETELY STOPPED, PRESS [EXTRACT] BUTTON AGAIN.** If such stop continues during the operation, the parts may be damaged and performance may be deteriorated due to overheating in a motor. When the problem continues, stop the appliance immediately and contact your local Customer Service Center.
- **DURING THE OPERATION, DO NOT ATTEMPT TO MOVE THE BODY, DISASSEMBLE THE CHAMBER SET OR PARTS AND TRY TO LOCK THEM.** It may cause an injury or a failure. If needed, switch off first and unplug the power cord.
- **WHEN USING THE APPLIANCE, BE CAREFUL WITH CLOTHING AND ACCESSORIES (SUCH AS A NECKTIE, LONG NECKLACE, SCARF, ETC.) SO THEY ARE NOT ENTANGLED INTO THE HOPPER CHUTE.** It may cause injury, failure or breakage.
- **PLACE THE APPLIANCE ON A FLAT AND STABLE SURFACE.** It may cause injury or failure.
- **WHEN PLACING INGREDIENTS INTO THE HOPPER CHUTE, USE ONLY THE PUSHER PROVIDED.** It may cause injury or failure.
- **DO NOT ALLOW THE APPLIANCE TO EXPERIENCE A SEVERE SHOCK, OR DROP IT.** It may cause electric shock, fire or damage.
- **IF THE APPLIANCE GIVES OFF AN UNPLEASANT SMELL, EXCESSIVE HEAT, OR SMOKE, STOP USING IMMEDIATELY AND CONTACT YOUR LOCAL CUSTOMER SERVICE CENTER.**
When using a new appliance, there may be a smell that disappears gradually over time.
- **ALWAYS UNPLUG THE APPLIANCE AFTER USE. ALWAYS DISCONNECT THE APPLIANCE FROM THE SUPPLY IF IT IS LEFT UNATTENDED AND BEFORE ASSEMBLING, DISASSEMBLING OR CLEANING. WHEN UNPLUGGING THE POWER CORD, MAKE SURE TO HOLD THE POWER CORD.** Pulling the wire to unplug may cause electric shock or fire.
- **DO NOT WASH AT HIGH TEMPERATURES OF 80°C(176°F) OR HIGHER. DO NOT PUT THE APPLIANCE IN A DISHWASHER, DRYER OR A MICROWAVE, ETC.** It may cause a failure or parts deformation.
- **THE APPLIANCE WEIGHS ABOUT 6.5 kg (14.3 lb). WHEN MOVING THE APPLIANCE, MAKE SURE TO MOVE IT HOLDING GRIPS TIGHTLY AT THE BOTTOM OF BODY WITH BOTH HANDS.**
By attempting to hold chamber or the edge of the body, the body may fall causing an injury or failure.

PARTS

* Components may vary depending on the model.

01 Hopper

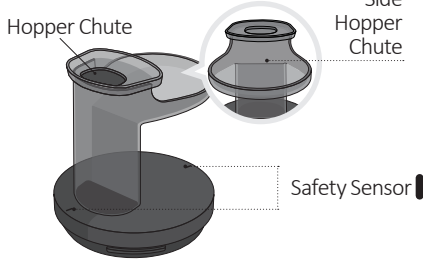

02 Spinning Brush

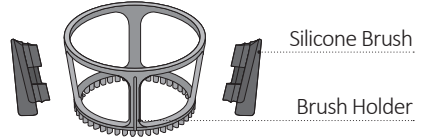

03 Squeezing Screw

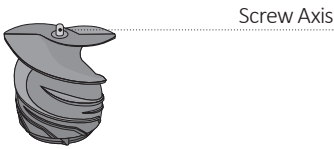

04 Chamber

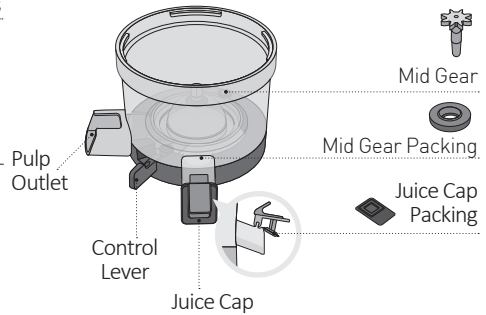

05 Pusher

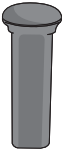

06 - 08 Strainer

06 Fine Strainer

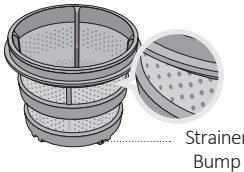

07 Coarse Strainer

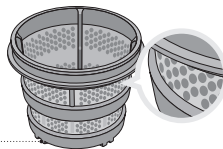

08 Ice Cream Strainer

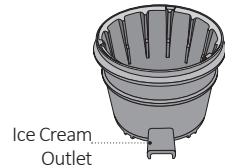

09 Juice Container Lid



10 Juice Container

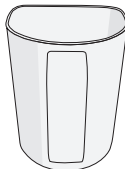

11 Pulp Container

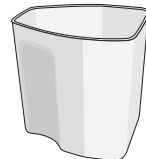

PARTS

12 Body

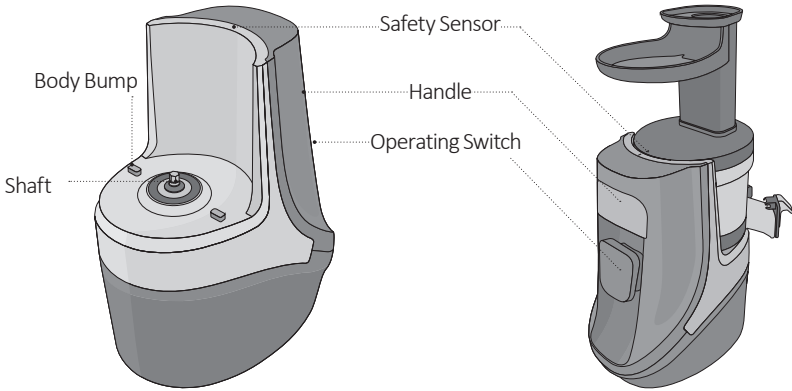

13 Cleaning Brush

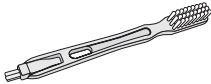

14 Small Cleaning Brush



15 Tofu Set

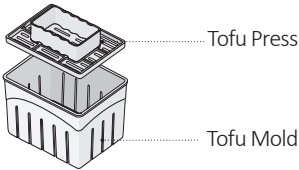

16 Chamber Rack

*Chamber Rack can't be separated after assembling.

17 Squeezer Set

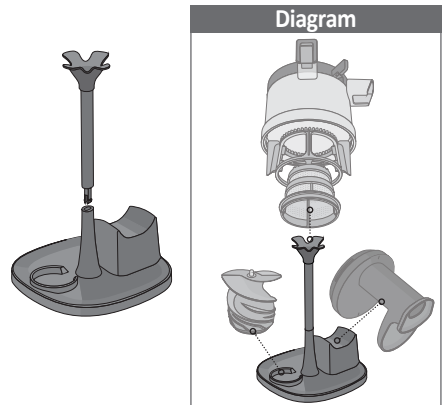
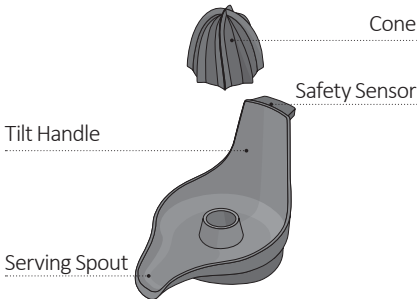

DISASSEMBLING THE CHAMBER

*Please clean all the parts before first use.

- 1 Turn the hopper counterclockwise and pull upwards.

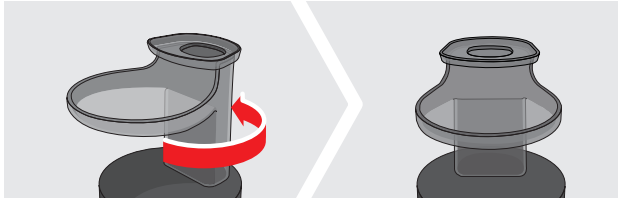

- 2 Remove the strainer and spinning brush from the chamber.

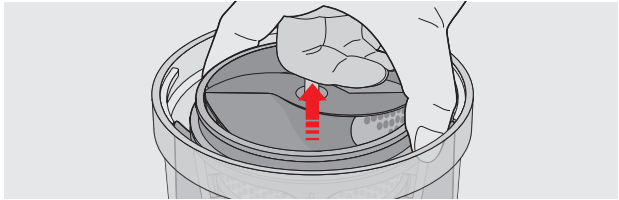

- 3 Hold both sides of the wing and pull out the squeezing screw.

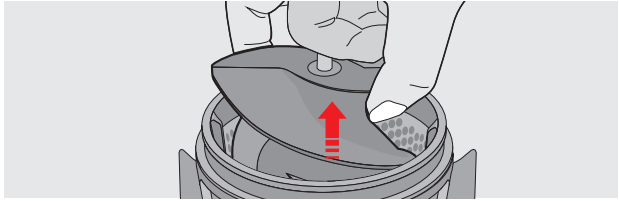

- 4 Remove the strainer from the spinning brush.

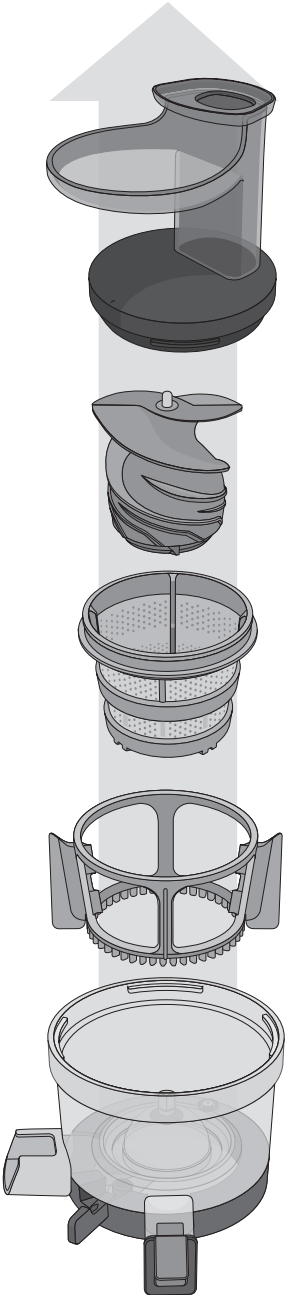
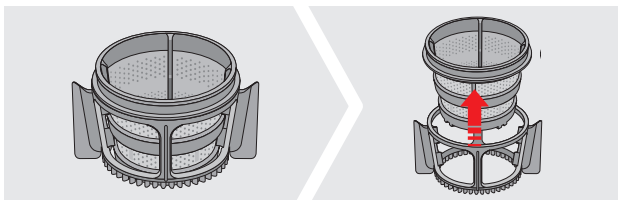

PREPARING INGREDIENTS

For juicing

Apple, pear, kiwi, Korean melon

Keep peel and seeds intact when juicing fruits such as pear, kiwi, Korean melon, etc.. Apple seeds contain toxins, so it is better to remove them before juicing.

Pomegranate, grapes

Separate each grape from the cluster. Peel the pomegranate and use seeds only.

Watermelon, orange, grapefruit

Peel outer rind of watermelon and citrus fruits. Cut them into appropriate sizes.

Mango, cherry, peach

Mango, cherry, peach, plum, etc., have hard seeds that cannot be chewed. Do not put these seeds in the juicer, as they may cause stoppage or damage to parts. Use only the fruits' flesh.

Wheatgrass, chives

Insert a neat handful at a time, making sure that they do not get scattered.

Water parsley, kale, angelica, celery

Cut fibrous ingredients into sizes 2 inches or smaller.

For making ice cream

Fruit flesh

Dice frozen fruits into 1 inch pieces when making ice cream. Melons should be peeled then frozen before use. Fruits with seeds that are too hard to chew, such as persimmon, apricot, lemon, plum, peach etc., should have the seeds removed before freezing. Choose seedless grapes for freezing.

- ▶ This is only a reference on how to prepare ingredients. If you have any allergies, please choose the proper ingredients according to your needs.
- ▶ Please refer to the recipe book on how to use the product according to ingredient.

USE BY STRAINER TYPES

Coarse strainer

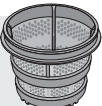

Coarse strainer has larger holes for making thick and pulpy juice. Works best to make thick juice with soft fruits like banana and strawberry, and is also useful for smoothies, lattes, or soups.

Fine strainer

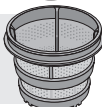

Fine strainer has small, fine holes for making clean juice.

Ice cream strainer



Ice cream strainer is for making smoothies, slush and ice cream with frozen fruits.

Do not extract large chunks or large amounts of ingredients at once.

As the fruit defrosts inside the chamber, juice may form inside or even come out of the pulp outlet. This is completely natural, not a product failure. Do not use water-frozen ice cubes.

Note

**This ice cream strainer is only for frozen fruits.
Do not use for crushing ice and/or grinding.**

ASSEMBLING THE CHAMBER FOR JUICING

STEP

1

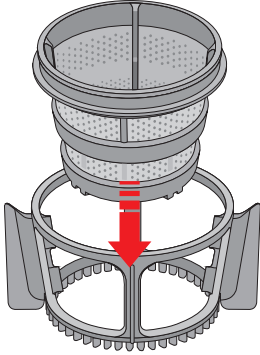

Assemble the strainer and spinning brush as shown.

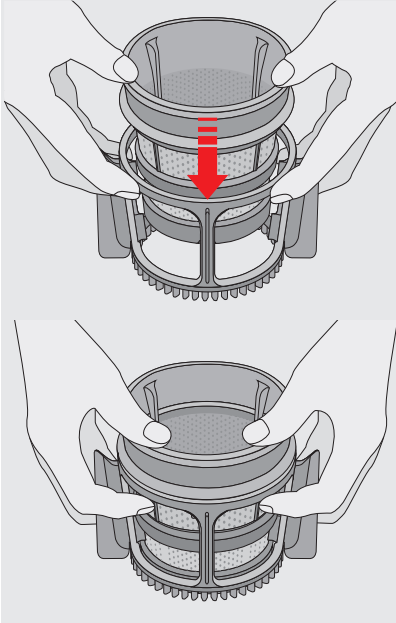

STEP

2

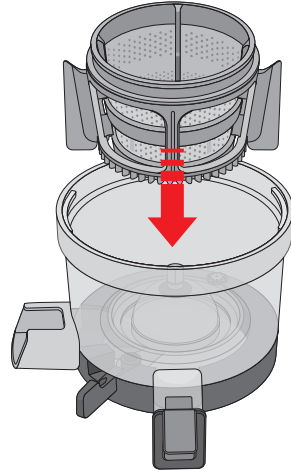

Place the assembled parts from [STEP1] into the chamber. Twist the strainer from side to side so that the bottom bump of the strainer fits the groove of the chamber.

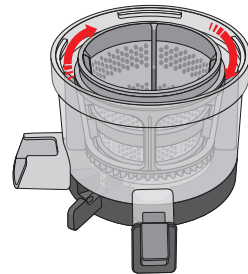
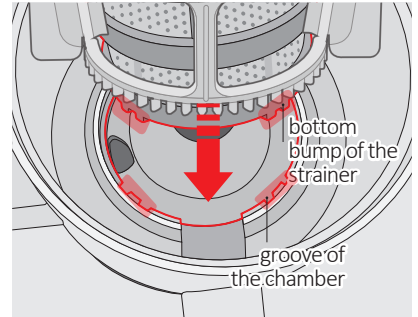

ASSEMBLING THE CHAMBER FOR JUICING

STEP
3

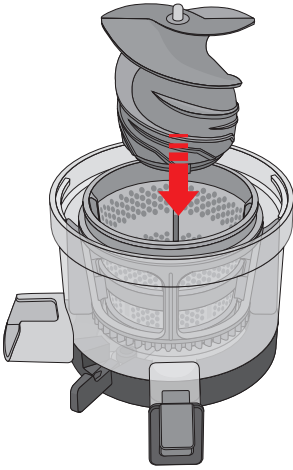

Press the squeezing screw into the assembled parts from [STEP 2] until the screw fits perfectly.

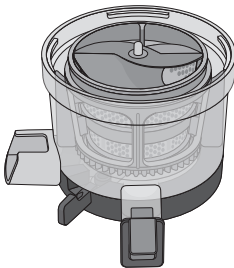
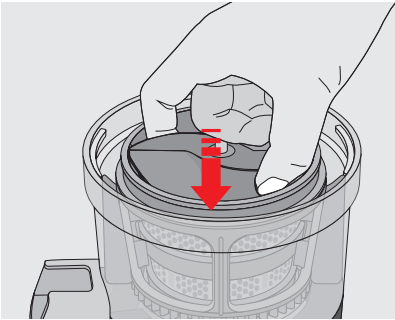

STEP
4

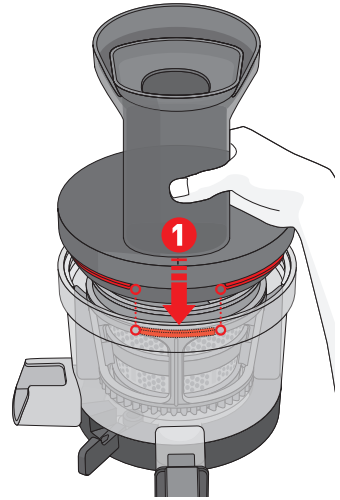

Assemble the hopper as shown. After fitting the hopper on the chamber, turn clockwise until it locks completely.

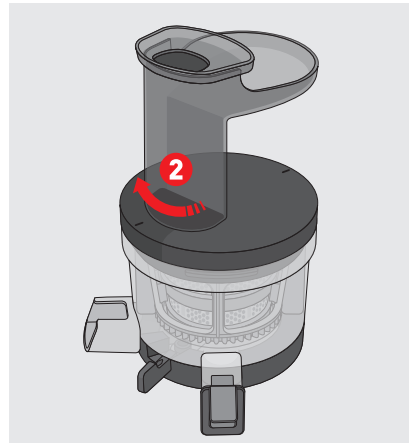

NOTE

The appliance works even if the hopper is assembled in the opposite direction.



ASSEMBLING THE CHAMBER FOR MAKING ICE CREAM

STEP

1

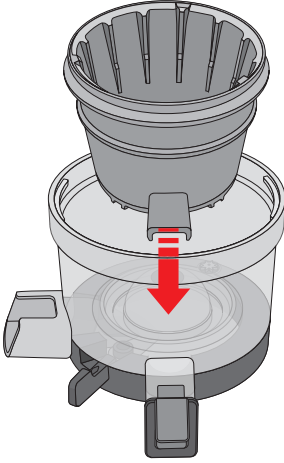

Place ice cream strainer in the chamber. Align the ice cream outlet of the strainer with the juice outlet of the chamber.

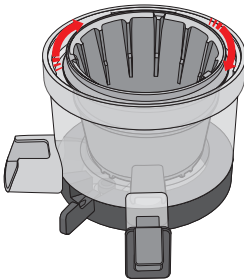
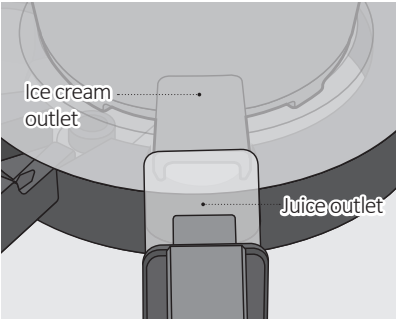

STEP

2

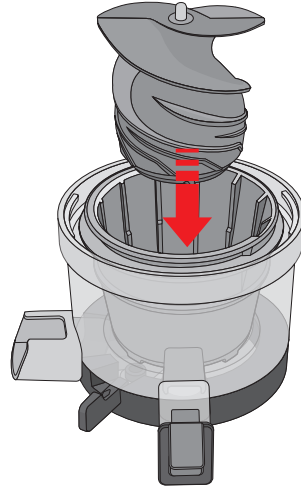

Press the squeezing screw into the assembled parts from [STEP 1] until the screw fits perfectly.

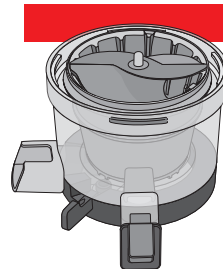

Note

The spinning brush is not needed for ice cream making.

ASSEMBLING THE CHAMBER FOR MAKING ICE CREAM

STEP

3

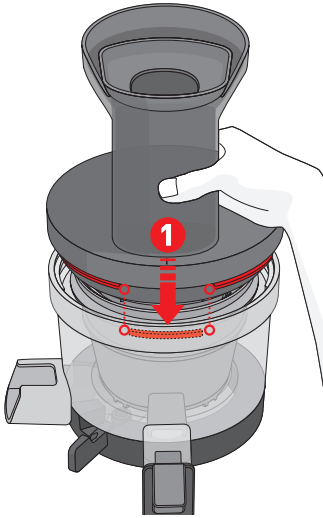

Assemble the hopper as shown. Place the hopper on the chamber and turn clockwise until it is completely locked.

**Note**

The appliance works even if the hopper is assembled in the opposite direction.



ASSEMBLING THE CHAMBER SET AND BODY

*The assembly method is the same regardless of strainer type.

- 1** Place the control lever of the chamber to **●** CLOSE as shown in Image **1**.

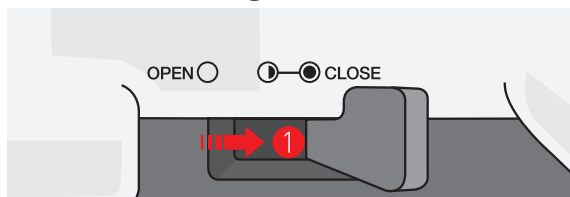

- 2** Fit the bottom of the chamber to the body bump.
If the control lever is not placed on **●** CLOSE the chamber set and body will not fit completely.

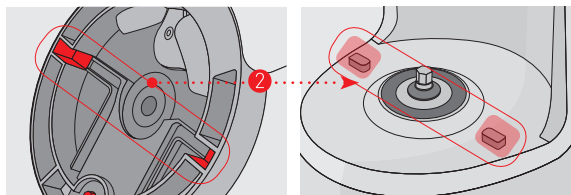

- 3** Align the the **<|>** sign on the body and the sign **<|>** on the chamber set.

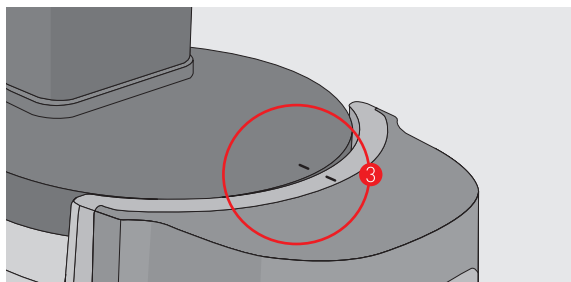

Note

1. The body on its own (without the chamber) will not work.
2. If the chamber is not properly assembled, the appliance will not work.

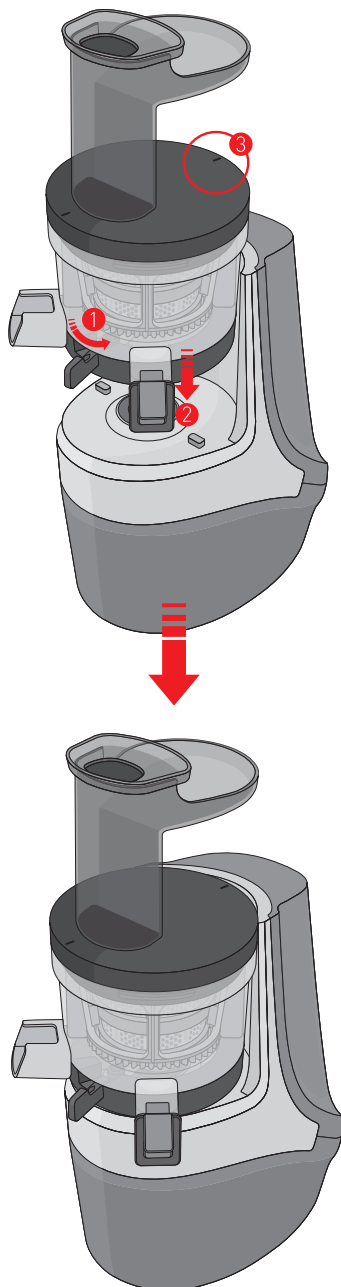

CAUTIONS DURING OPERATION

* **Ingredients that require caution.**

- Fruits with hard seeds that are hard to chew, such as persimmon, Japanese apricot, lemon, plum, peach etc. should have the seeds removed and not extracted.

- Stalk vegetables with tough fiber, such as water parsley, celery, etc., should be cut into small sizes of about 1-2 inches before insertion.

- Do not insert sesame seeds, coffee beans, tree bark, etc. These cannot be extracted.

- Do not insert fruits preserved in alcohol, sugar, honey, etc. (grapes, apricot, berries, etc.) and/or succulents (glasswort, leek, etc.).

* **It is recommended to drink green vegetable juice and fruit juice immediately after extraction, rather than keeping them for a long time.**

* **Do not use for grinding grains.**

- It may cause product damage or failure.

* **Do not re-insert the expelled pulp back into the juicer.**

* **Do not operate the appliance before putting in the ingredients.**

* **Do not use the appliance for more than 30 minutes continuously.**

- May cause a failure due to the motor overheating.

- When using continuously, stop the appliance after 30 minutes and allow at least 5 minutes of rest before using it again.

* **Never insert your finger(s), a fork or knife, or any other object into the juice outlet during operation.**

- Inserting extraneous items into the juice outlet (such as fingers or spoons) during operation may cause them to get stuck into the spinning brush and cause damage.

* **Do not press ingredients with anything other than the included pusher.**

- May cause damage, injury, and failure.

* **Do not operate the switch with wet hands.**

- May cause electric shock or fire. Do not get liquids on or near the switch.

* **When extracting over 400ml at once, please switch the control lever to HALF-CLOSED every 400ml to help emit the pulp.**

- Keeping on CLOSE increases pressure inside the chamber, preventing the hopper from opening, and/or may cause damage.

* **Please only use thawed frozen fruits with the ice cream strainer. Do not put in ice cubes or other ingredients for grinding.**

- May cause damage or failure.

NOTE

Ingredients kept in the refrigerator long-term may become withered, which in turn may make small amounts of juice or even no juice at all.

If the unit is not cleaned immediately after use, residue may dry and stick to the unit. This will make assembling and cleaning difficult as well as lead to performance degradation.

USING THE PRODUCT : For juicing / Ice cream

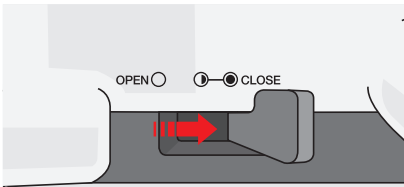

- 1 Place the control lever to the CLOSE (● CLOSE) position before operating.**

The chamber cannot be assembled correctly if the control lever is not on CLOSE (● CLOSE) position.

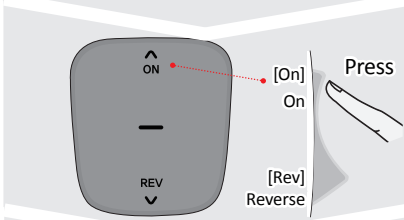

- 2 Press the [ON] button to start.**

If the appliance does not start, please check that the chamber set is correctly assembled.

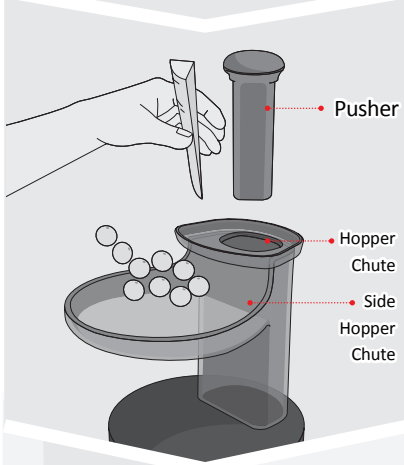

- 3 Put ingredients in the hopper chute gradually and press with the pusher (if needed).**

Do not press the ingredients with anything other than the pusher provided.
Please prepare the ingredients into 1 to 2 inch sizes.

When using thawed ingredients with the ice cream strainer, some juice may come out through the outlet. This is normal.

When extracting over 400ml at once, please open the control lever (switch to "half-closed") every 400ml to emit the pulp.

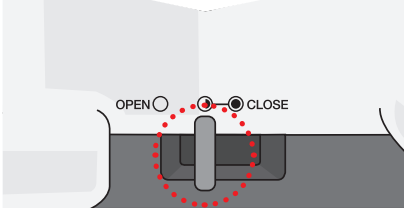

- 4 Juice : Place the control lever on half-closed (◐) when inserting the last of your ingredients. Ice cream : Keep the control lever on Close (● CLOSE)**

As long as the pulp in the strainer is properly released, the hopper will open easily.

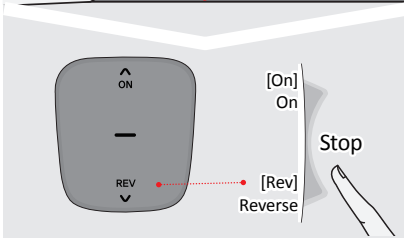

- 5 Once extraction is complete, press the [REV] button once to stop the machine.**

The appliance will slowly come to a stop.

NOTE

Make sure that the squeezing screw is completely stopped when switching between [ON] and [REV].

USING THE CONTROL LEVER BY MODE

- * The control lever is between the juice outlet and pulp outlet.
- * The control lever can help extract the most out of various ingredients.

[● CLOSE] Preparation/Extraction mode

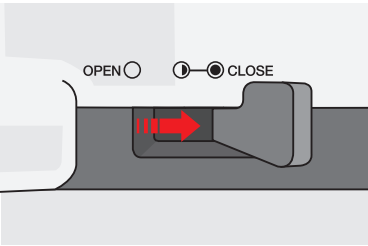

For most ingredients, the extraction rate is good when you close (● CLOSE) the control lever during operation. When extracting over 400ml at once, please open the control lever every 400ml to emit the pulp.

For juicing fruits with small, firm seeds, such as grapes and pomegranates, place the control lever on close (● CLOSE) and switch to half-closed (◐) position once the juice begins to fill the chamber.

[● CLOSE] Ice cream mode

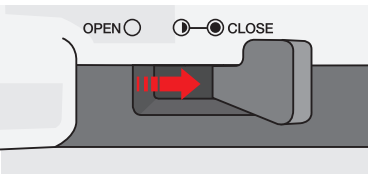

Since there is no pulp to be released separately, keep the control lever on close (● CLOSE).

[◐] Completion, Simple Cleaning Mode

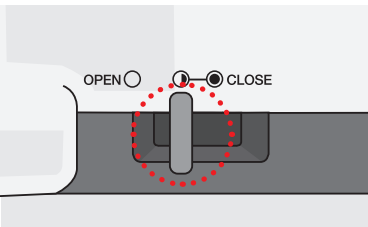

Place the control lever on the half-closed (◐) position when putting in the last of the ingredients and release the remaining pulp. The hopper will open easily when the pulp in the strainer is released.

For Simple Cleaning Mode, place the control lever on the half-closed (◐) position and release the pulp.

[○ OPEN] Cleaning Mode

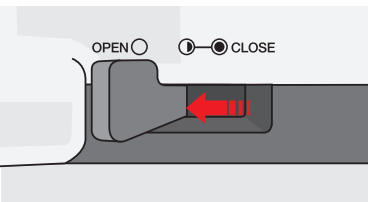

When detaching and cleaning the chamber, place the control lever completely on the (○ OPEN) position. You can easily and conveniently clean the chamber.

NOTE

If it is hard to open the hopper after operation : Place the control lever to half-closed (◐) and press the Reverse button for about 3 seconds. Repeat this for 2 to 3 times and the hopper should open easily.

USING THE CONTROL LEVER BY INGREDIENT (Juicing)

Ingredients

Apple, pear, melon, watermelon, strawberry, blueberry, orange, grapefruit, lemon, mango, plum, peach, cherry, persimmon, pineapple, wheatgrass, parsley, celery, dandelion, carrot, ginger, potato, beet, tomato, bell pepper, broccoli, cauliflower, cabbage, kale, spinach, cooked sweet potato and pumpkin, corn

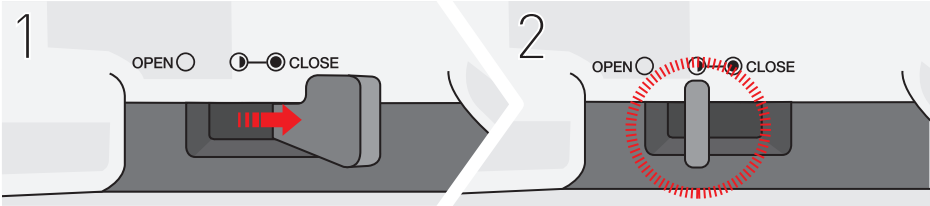

1. Start on ● CLOSE position.

2. When extraction is almost finished, place the control lever on, ● Half-Opened position

Ingredients with seeds

Grapes, pomegranate, blackberry, kiwi

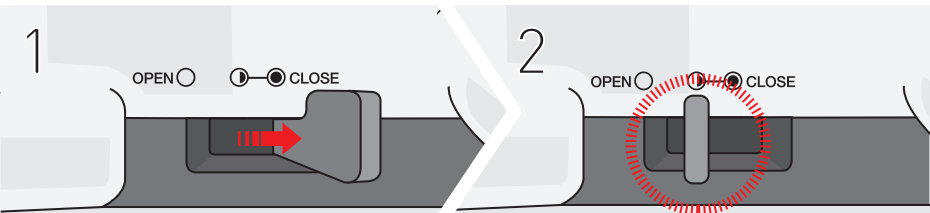

1. Start on ● CLOSE position.

2. When juice begins to fill chamber, place the control lever on the ● Half-Opened position.

Mixed with milk

Banana, strawberry and blueberry, etc.

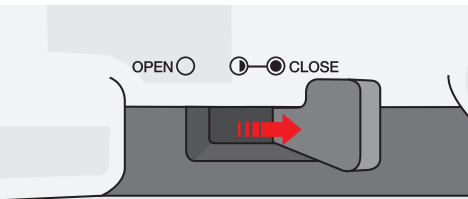

1. Start on ● CLOSE position.

IF THE SQUEEZING SCREW STOPS DURING OPERATION

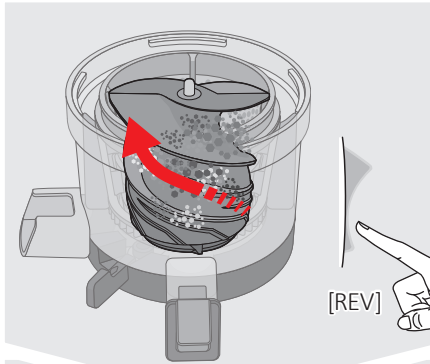

- 1** Press **[REV]** button on the operating switch for about 3-5 seconds then stop. Repeat this 2-3 times.

Press on the [REV] button to push the ingredients back upward.

The [REV] button only works while pressing down on it, the squeezing screw stops rotating if you release the button.

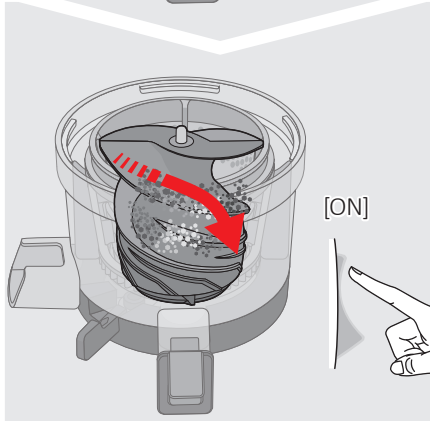

- 2** Press **[ON]** button to operate after reverse operation is completely stopped.

When switching between the [ON] and [REV] buttons, make sure the squeezing screw stops completely.

NOTE

If the above directions do not work, please unplug the power cord, disassemble and clean the chamber set, and try the above again.

Caution when using operation button



NOTE

In case of reversing during operation, press [REV] button shortly to stop the appliance, then press [REV] button for operation.

From the feature of the product, even though you stop the operation, it doesn't stop right away. It rotates slowly then stops. If the rotation stops completely, you may press the button to any direction you want.

ASSEMBLING AND CLEANING THE SQUEEZER

Assembling the squeezer set on the body

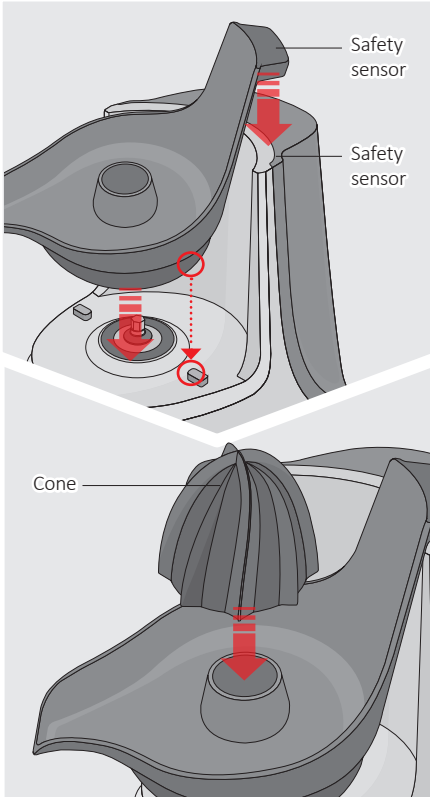

- 1 Mount the serving spout on the body.**
Align the grooves on the bottom of the serving spout with the body bumps.

- 2 Fit the cone onto the spin axis on the body.**

Cleaning

1. Turn completely off and the remove the plug from the power outlet before cleaning.
2. Remove the cone and serving spout from the body and clean the parts under running water.
3. Rinse or wash all squeezer parts immediately after use. Dried pulp is difficult to clean.

NOTE

**DO NOT WASH AT HIGH TEMPERATURES OF 80°C OR HIGHER.
DO NOT PUT THE APPLIANCE AND PARTS IN A DISHWASHER,
DRYER OR A MICROWAVE ETC.**

It may cause a failure or parts deformation.

USING THE SQUEEZER

How to use the squeezer

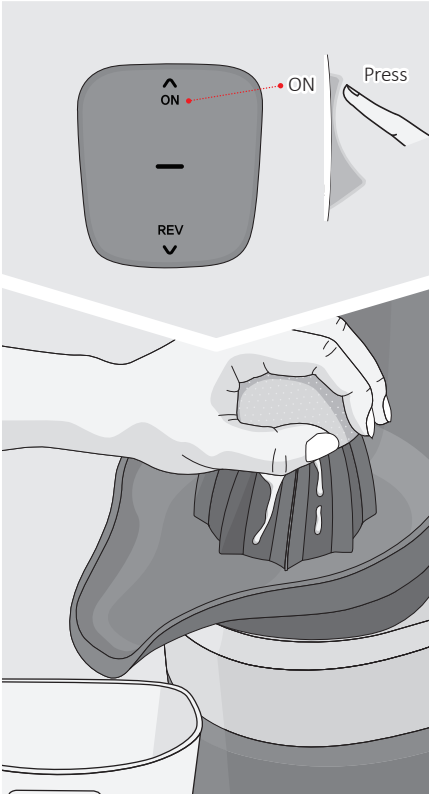

1 Press the [ON] button to turn on.
Prepare the juice cup under the serving spout.

2 Cut the citrus fruit in half. Place one of the halves onto the cone, flesh-side down, and push down gently.

If you extract an excessive amount of ingredients, it may overflow.

Cautions

- Remove seeds before extraction, or your juice may contain seeds.
- If you want clear juice, use the Hurom chamber for juicing.
- Please wash all fruit thoroughly before extraction.
- Please use fruit at room temperature, rather than frozen fruit, for greater yield.
- We recommend you drink your juice immediately after extraction rather than keeping it for a long time.

CLEANING

Cleaning parts

- 01 Unplug the power cord of the fully stopped unit using dry hands.
- 02 Remove the chamber set from the main body. Twist the hopper to open and lift out the parts in order to disassemble the unit.
- 03 Using a cleaning brush, wash the chamber set under running water.
- 04 Open the control lever (OPEN ) and juice cap to wash out the chamber.
- 05 Wipe the main body with a damp towel or a soft cloth.
- 06 The silicone packing can be disassembled and washed. (Including juice cap packing, chamber packing, silicone brush)
- 07 Soak in water diluted with one or two drops of baking soda or natural bleach for dishes for about 30 minutes to sterilize and clean.

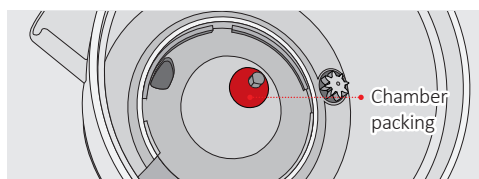

The chamber packing can't be disassembled. Do not disassemble the chamber packing. If you try to disassemble the chamber packing, it might be damaged.

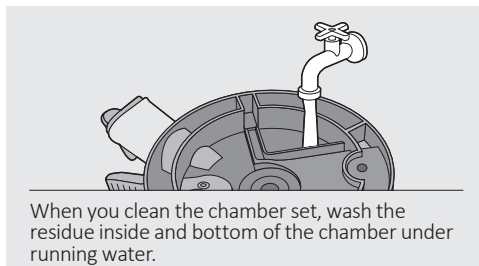

When you clean the chamber set, wash the residue inside and bottom of the chamber under running water.

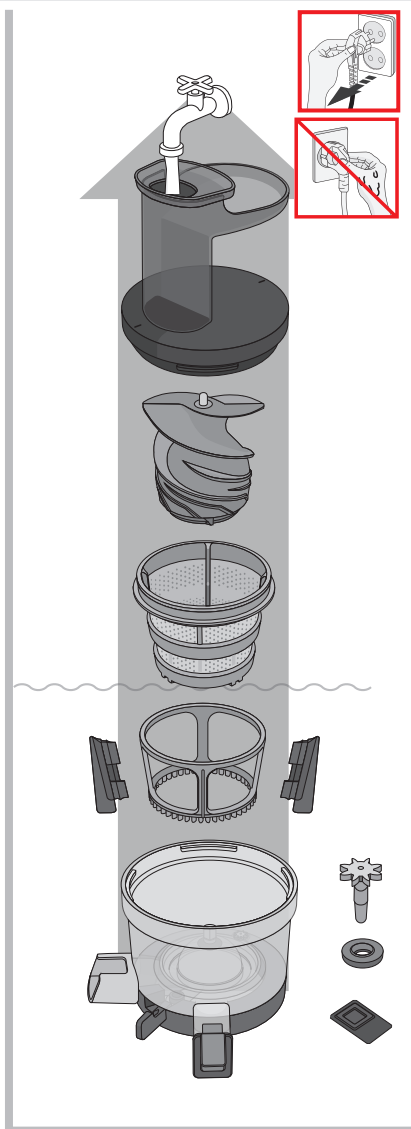

NOTE

1. If the chamber is not cleaned immediately after use, residue may dry and stick to the unit. This will make disassembling and cleaning difficult as well as lead to performance degradation. Please wash the chamber set immediately after use.
2. Do not wash with hot or boiling water, an iron scrubber, abrasive material, sink solvents, or sharp cleaning tools. Do not put it in a dishwasher or dish dryer. After washing, thoroughly and naturally dry, and store in a clean area.

CLEANING: SILICONE PARTS

Juice Cap Packing

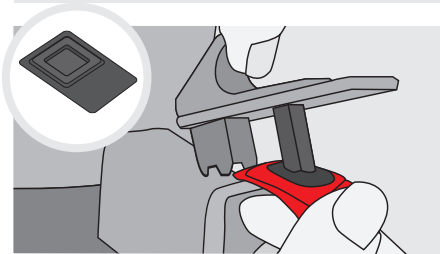

Open the juice cap. Hold the chamber and juice cap with one hand, and remove the juice cap packing with the other hand to disassemble.

Please be careful not to drop or damage the juice cap and chamber when disassembling the unit.

Mid gear and Mid gear packing

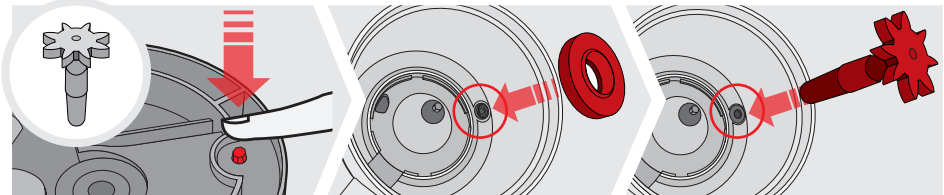

If you push on the mid gear from the under-side of the chamber, the gear will pop out.

After cleaning the chamber set, make sure the mid gear packing is in place.

Place the mid gear back into its appropriate spot inside the chamber only after the mid gear packing is set in place.

Spinning Brush

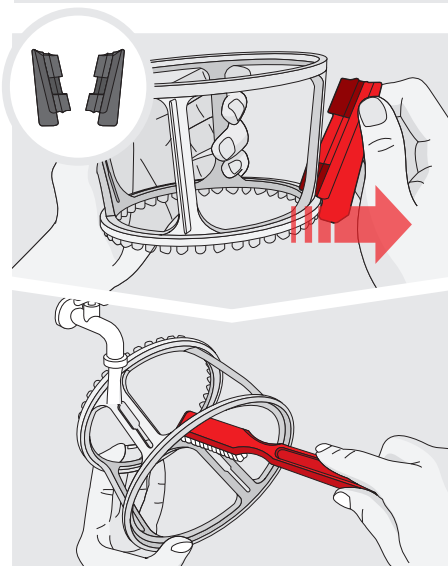

1 Remove the silicone brush from the spinning brush holder.

Pull on the silicone brush outward (as shown in the diagram to the left). Please follow the above method to prevent damage of spinning brush holder and silicone brush.

2 Using a cleaning brush, wash the inside and outside of the spinning brush holder under running water.

Wash the silicone brush under running water using the same method.

TROUBLESHOOTING

If you need additional assistance or information, please contact your local Customer Service Center or visit www.hurom.com. When requesting for service or repairs after purchase, please have the serial number or bar code available.

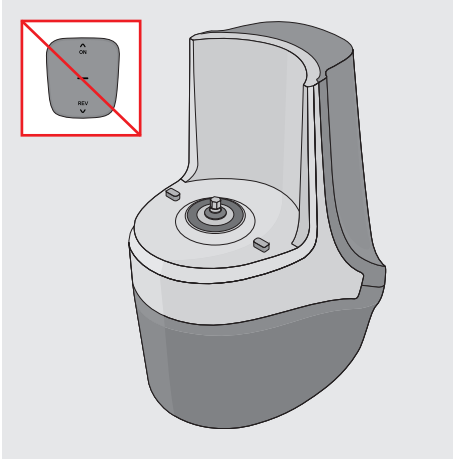

1. The main body will not work.

For your safety, this unit only works when it is correctly assembled with the chamber set.

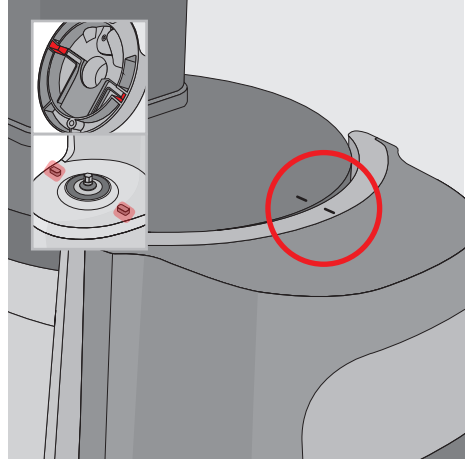

2. Please align the safety sensor.

For your safety, this unit only works when it is correctly assembled.

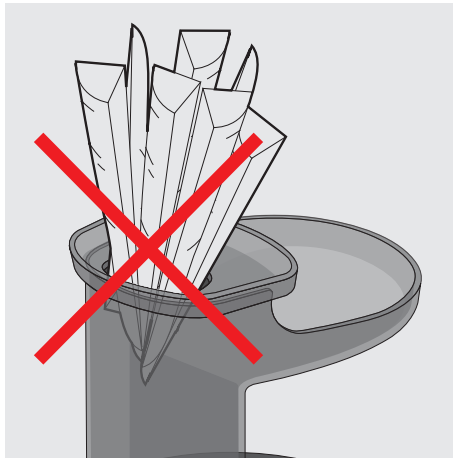

3. Do not insert too many ingredients at once.

If you insert an excessive amount of ingredients or ingredients that are too large, the unit may stop.



4. Do not press on ingredients using anything other than the pusher in the hopper chute.

It may cause damage, injury, etc.

5. The appliance does not work.

Make sure that the power cord is properly plugged in.

Check that the hopper is properly assembled.

For safety reasons, if the hopper has not been locked into place, the appliance will not operate.

Check if the appliance is assembled according to the directions in the manual.

Refer to manual for assembly instructions or consult with your Customer Service Center for additional assistance.

6. The appliance stops during normal operation.

Make sure you haven't inserted heavy loads or large pieces of ingredients into the appliance.

Refer to page 17 of the manual and follow the guideline for using the [REV] button.

If the issue is not resolved after following the above process, please contact your local Customer Service Center.

7. The hopper does not open.

There might be a lot of residue (pulp) built up inside.

Put the control lever in half-closed (Ⓢ) position, and press [ON] button to release residue. Press [REV] button for 3-5 seconds then stop. Repeat this process 2 to 3 times.

Have you placed any foreign substances or solid objects (hard seeds such as cherry seeds) in the juicer?

Press [REV] button to push the ingredients back up the hopper chute.

Do not attempt to open by force.

Please contact your local Customer Service Center for assistance.

8. Juice leaks over the body.

Have you inserted a lot of ingredients into the hopper chute?

If the amount of ingredients inserted is too much compared to the amount coming out of the pulp outlet, the packing becomes slightly pushed away creating a gap, so the juice leaks out. Do not put too many ingredients in by force, but gradually when extracting.

9. There are fine lines or scratch marks around the squeezing screw.

These are completely normal "molding marks" resulting from the manufacturing process. There are no problems for use.

10. The chamber shakes when squeezing.

The motor may cause slight shaking.

Depending on the texture of the ingredient, there may be slight shaking as the squeezing screw rotates. This is a normal phenomenon and is not a malfunction. Firm ingredients (e.g. carrot, potato, radish, beet, etc.) may cause more shaking than softer ingredients.

11. The chamber shakes when squeezing.

If the control lever is in the OPEN ○ position, the chamber set will not fit onto the body. Before assembling the chamber set, make sure that the control lever is in the ● CLOSE position.

Product Specifications

● Product Name	Hurom Slow Juicer	● Cord Length	1.4 m
● Model Name	H-AF Series	● Motor	Single-phase induction motor
● Rated Voltage	120 V	● Fuse	250 V 8 A
● Rated Frequency	60 Hz	● Weight (Chamber set included)	6.5 kg (14.3 lb)
● Rated Power Consumption	150 W <small>Energy efficiency is low at high rated power consumption(W).</small>	● Squeezer Weight	205g
● RPM	43 rpm	● Outward Dimension	Width 270 mm Length 180 mm Height 430 mm
● Rated Operating Hour	Less than 30 minutes	● Squeezer Dimension	Width 137 mm Length 191 mm Height 137 mm

Warranty

● Product name

● Customer name

● Model name

● Supplier

● Date of purchase

● Address

● Manufacture's serial number

1. Important: To better protect your purchase, fill out and mail this form to a local distributor where you purchased the appliance and keep the original receipt.

2. This certifies that the Hurom slow juicer is covered under warranty by **HUROM to be free from defects in material construction and workmanship.**

Hurom provides warranty for ten (10) years for the motor and two (2) years for other parts from the date of purchase by the original purchaser. Coverage is valid only with proof of purchase from an Authorized Local Distributor. (No international warranty available)

This warranty does not apply to damages caused by accident, misuse, abuse, commercial use, alteration, failure to follow operating instructions, or damage caused by parts or service unauthorized by **HUROM**. Damages caused by transportation must be claimed with carrier. **HUROM** disclaims all responsibilities for consequential damages from incidental losses caused by use of this appliance.

3. Please check the bottom of your Hurom product for a sticker with a barcode.

This barcode sticker helps verify a genuine Hurom product and identify the product manufacturing date. Hurom's manufacturer's warranty does not cover products with missing or damaged barcode stickers. Products are to be inspected upon receipt.

4. For service and assistance with technical difficulty, please contact our local customer care center.

HUROM

Manufacture : **HUROM**
Hurom webpage : www.hurom.com